



**CONNEX**

**ELECTRIC MOTOR**

## CSSTF36-213-72

### Stainless Steel - TEFC Three Phase Motor

NEMA Design B - High Efficiency - Inverter Duty - Squirrel Cage AC Motor

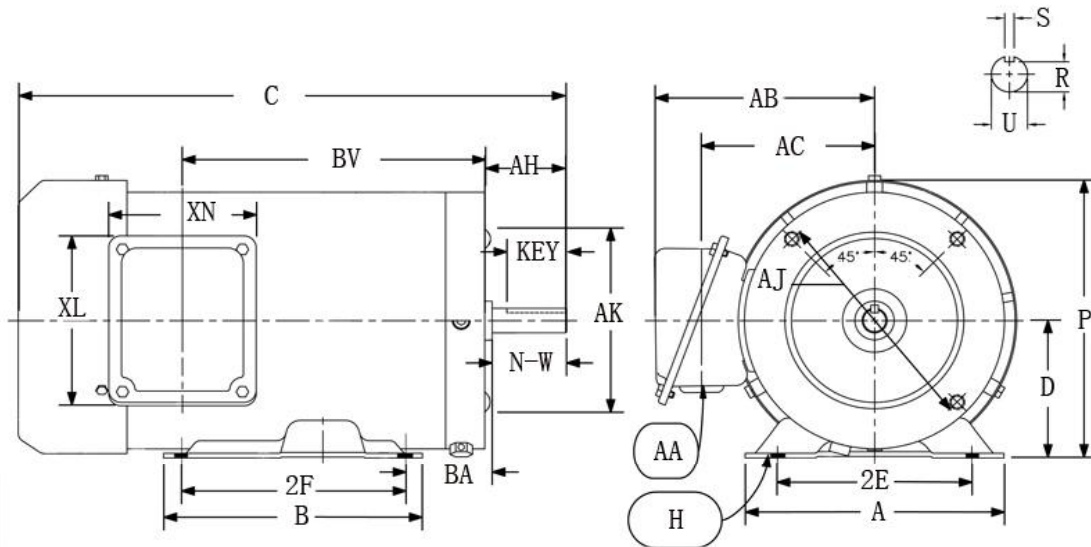

### DIMENSIONAL DATA

Mounting							Conduit Box						
D	E	2F	A	B	BA	H	AB	AC	XL	XN	AA		
5.25	4.25	5.5	10	8.5	4.25	.71x.47	7.6	6.2	4.45	4.05	0.94		
Motor dimensions						Keyseat			Bearings		Enclos.	F/R	
C	AH	AJ	AK	P	N-W	U	R	KEY	ODE	DE			
21.50	3.12	7.250	8.5	10.0	3.38	1.375	1.201	2.41	6208zz	6308zz	TEFC	FOOT	

### PERFORMANCE DATA

Three Phase - 50/60 Hz - Class F Insulation - 40°C Ambient - Continuous Duty - 1.15 Service Factor

HP	Frame	Full Load RPM	Efficiency%			Power Factor		Amps@460v		Full Load Torque (lb-ft)	Locked Rotor Torque (%FLT)	Pull Out Torque (%FLT)	Approx Weight (lbs)
			100% F.L.	75% F.L.	50% F.L.	100% F.L.	75% F.L.	Full Load	Locked Rotor				
7 1/2	213TC	3520	88.5%	87%	85%	0.85	0.83	9.4	63.0	11.1	200%	265%	110