



CONNEX

ELECTRIC MOTOR

CSSTF36-184-05JM

Stainless Steel - TEFC Three Phase Motor

NEMA Design B - High Efficiency - Inverter Duty - Squirrel Cage AC Motor

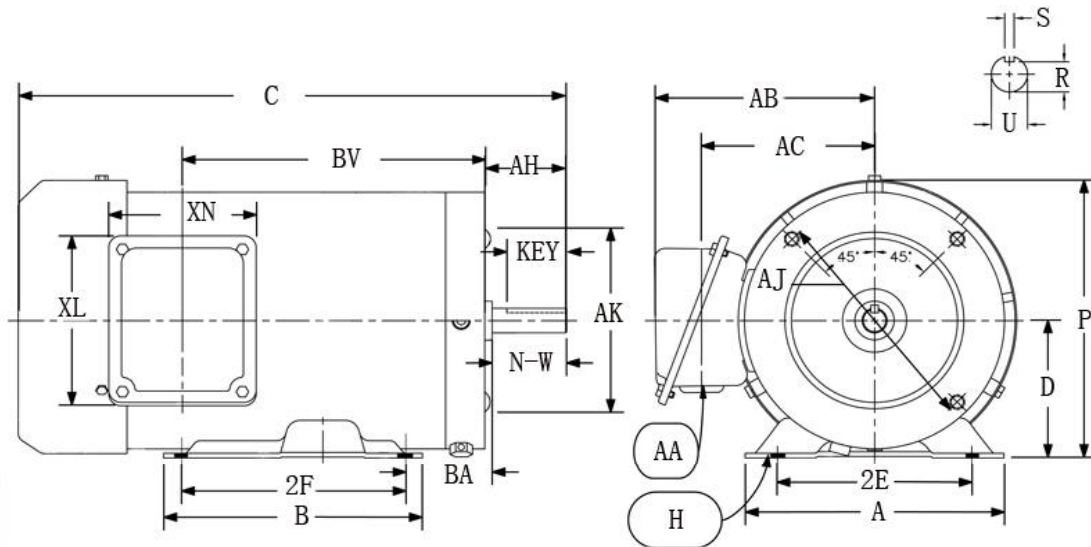

DIMENSIONAL DATA

Mounting							Conduit Box						
D	E	2F	A	B	BA	H	AB	AC	XL	XN	AA		
4.5	3.75	4.5	8.8	6.5	3.5	.71*.47	7	5.3	4.45	4.05	0.94		
Motor dimensions						Keyseat			Bearings		Enclos.	F/R	
C	AH	AJ	AK	P	N-W	U	R	KEY	ODE	DE			
18.06	4.28	5.875	4.5	8.9	4.25	0.875	0.771	1.65	6307Z	6307Z	TEFC	FOOT	

PERFORMANCE DATA

Three Phase - 50/60 Hz - Class F Insulation - 40°C Ambient - Continuous Duty - 1.15 Service Factor

HP	Frame	Full Load RPM	Efficiency%			Power Factor		Amps@460v		Full Load Torque (lb-ft)	Locked Rotor Torque (%FLT)	Pull Out Torque (%FLT)	Approx Weight (lbs)
			100% F.L.	75% F.L.	50% F.L.	100% F.L.	75% F.L.	Full Load	Locked Rotor				
5	184TC	3525	87.5%	85%	82%	0.91	0.67	5.9	46.0	7.3	216%	255%	90