



**CONNEX**

**ELECTRIC MOTOR**

## CSSTF18-145-02

### Stainless Steel - TEFC Three Phase Motor

NEMA Design B - High Efficiency - Inverter Duty - Squirrel Cage AC Motor

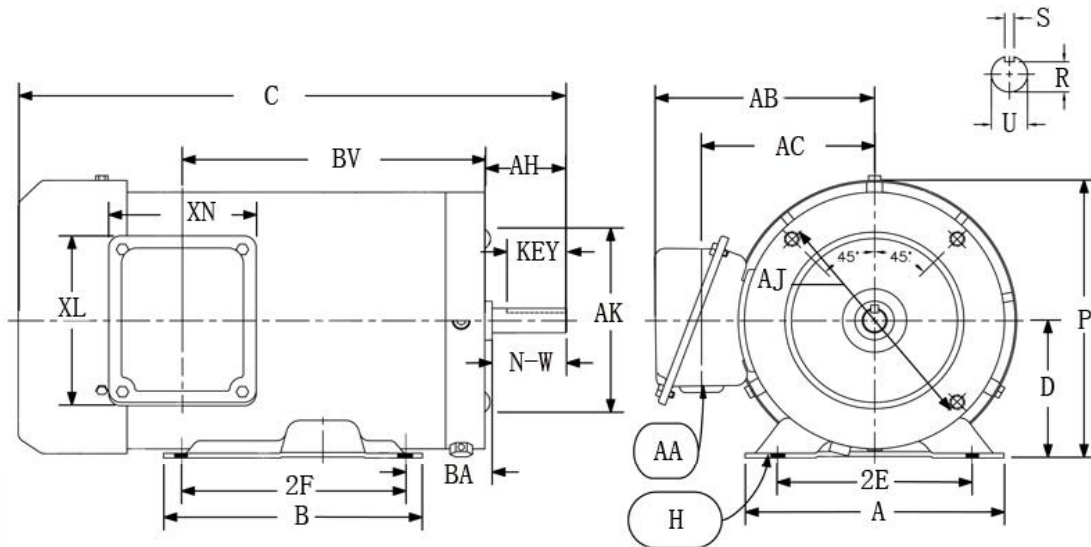

### DIMENSIONAL DATA

Mounting							Conduit Box						
D	E	2F	A	B	BA	H	AB	AC	XL	XN	AA		
3.5	2.75	4	6.5	6.5	2.75	1.22X.34	5.75	4.25	4.72	3.8	0.86		
Motor dimensions						Keyseat			Bearings		Enclos.	F/R	
C	AH	AJ	AK	P	N-W	U	R	KEY	ODE	DE			
13.68	2.12	5.875	4.50	6.50	2.25	0.875	0.517	1.41	6205Z	6205Z	TEFC	FOOT	

### PERFORMANCE DATA

Three Phase - 50/60 Hz - Class F Insulation - 40°C Ambient - Continuous Duty - 1.15 Service Factor

HP	Frame	Full Load RPM	Efficiency%			Power Factor		Amps@460V		Full Load Torque (lb-ft)	Locked Rotor Torque (%FLT)	Pull Out Torque (%FLT)	Approx Weight (lbs)
			100% F.L.	75% F.L.	50% F.L.	100% F.L.	75% F.L.	Full Load	Locked Rotor				
2	145TC	1740	84.0%	84%	83%	0.83	0.75	2.6	19.8	5.9	247%	323%	49