



**CONNEX**

**ELECTRIC MOTOR**

## CSSTF18-056-34-5

### Stainless Steel - TEFC Three Phase Motor

NEMA Design B - High Efficiency - Inverter Duty - Squirrel Cage AC Motor

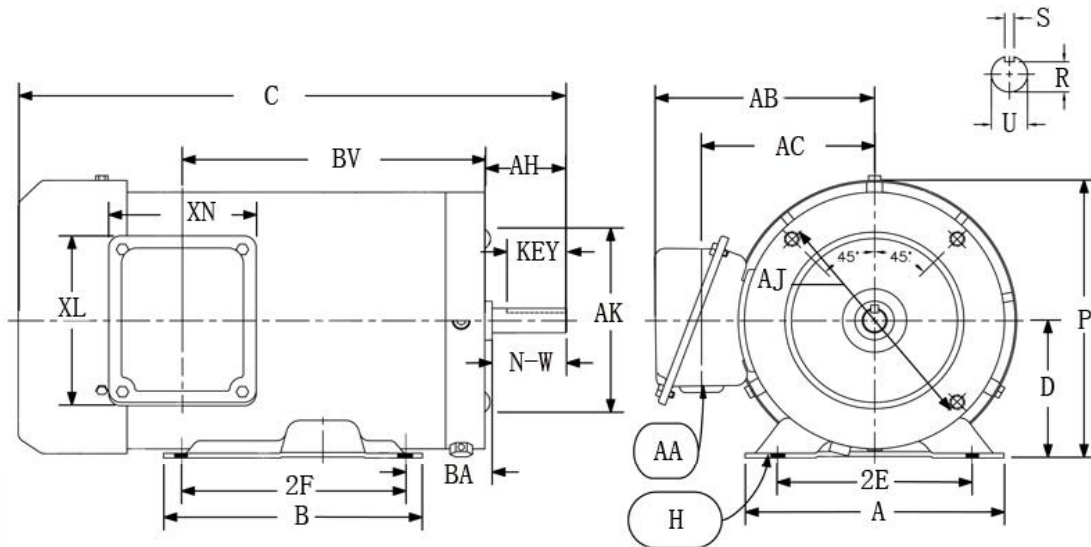

### DIMENSIONAL DATA

Mounting							Conduit Box						
D	E	2F	A	B	BA	H	AB	AC	XL	XN	AA		
3.5	2.44	3	6.5	6.5	2.75	1.22X.34	5.75	4.25	4.72	3.8	0.86		
Motor dimensions						Keyseat			Bearings		Enclos.	F/R	
C	AH	AJ	AK	P	N-W	U	R	KEY	ODE	DE			
11.59	2.06	5.88	4.50	6.50	1.88	0.63	0.52	1.41	6205Z	6205Z	TEFC	FOOT	

### PERFORMANCE DATA

Three Phase - 50/60 Hz - Class F Insulation - 40°C Ambient - Continuous Duty - 1.15 Service Factor

HP	Frame	Full Load RPM	Efficiency%			Power Factor		Amps@575V		Full Load Torque (lb-ft)	Locked Rotor Torque (%FLT)	Pull Out Torque (%FLT)	Approx Weight (lbs)
			100% F.L.	75% F.L.	50% F.L.	100% F.L.	75% F.L.	Full Load	Locked Rotor				
3/4	56C	1725	82.5%	77%	72%	0.78	0.72	1.1	7.2	2.2	227%	320%	33